

Disposal & Dismantling

Article number: 4309374
Light source: LT2592_module

Dismantling of LED driver and light source for disposal purposes

1. Disconnect the product from any power supply. Turn off safety cut-out or unscrew the protection fuse. The switch must be in OFF position.
2. Remove the screws from the lamp bracket.
3. Take off the lamp from the bracket.
4. Remove the screws from the LED driver.
5. Disconnect the wire and take out the LED driver. Dispose of the LED driver according to the relevant legal regulations.
6. Twist and take out the plate.
7. Unscrew the plate from the pole.
8. Remove the screws and take off the light source. Dispose of the light source according to the relevant legal regulations.

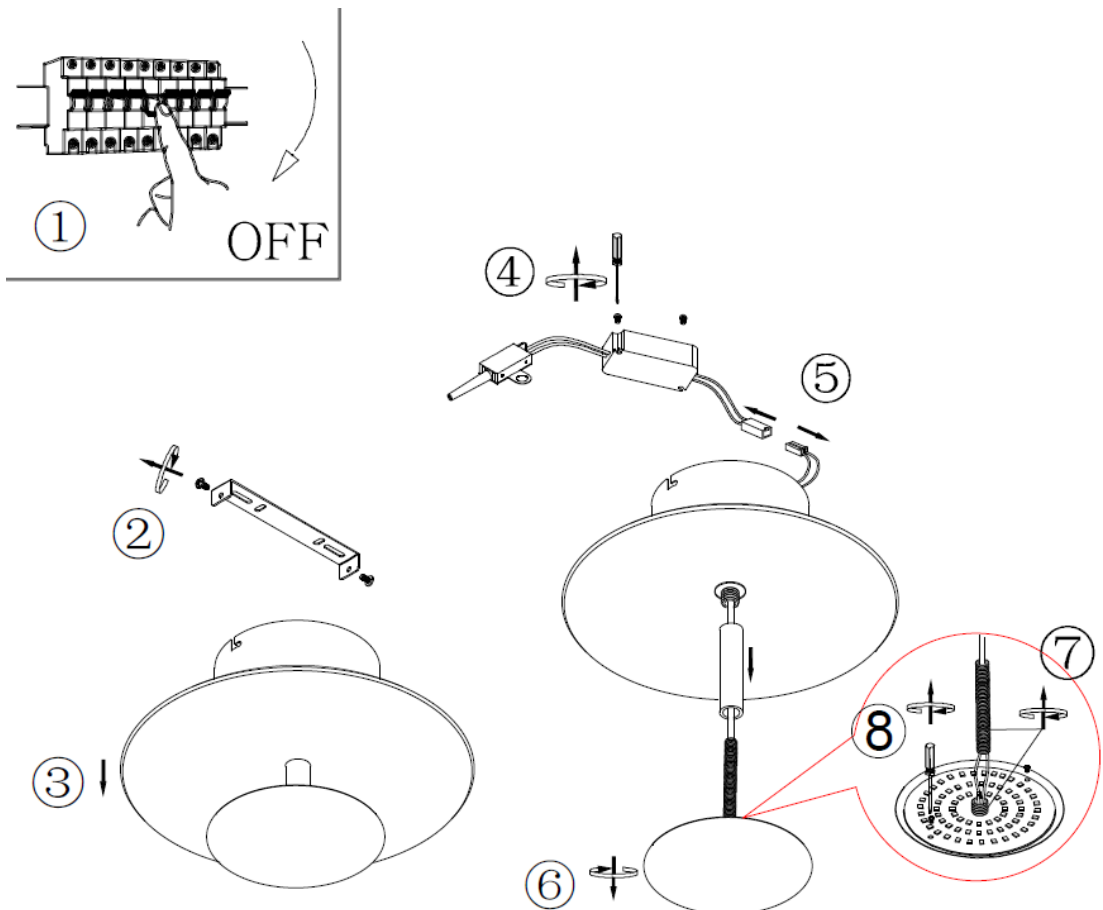

Manufacturer

DI-KA Vertriebsgesellschaft mbH & Co. KG
Oberstrasse 4
59755 Arnsberg
Germany
Tel: +49 2932 9022580
<http://www.di-ka.net/>